

STEPS TO BALANCE A CEILING FAN WITH A BALANCING KIT

STEP 1



TURN OFF THE FAN

Switch off the fan.

STEP 2



CLEAN THE BLADES

Wipe each fan blade to remove dust and buildup.

STEP 3



TURN OFF THE POWER

Shut off the power at the breaker for safety.

STEP 4

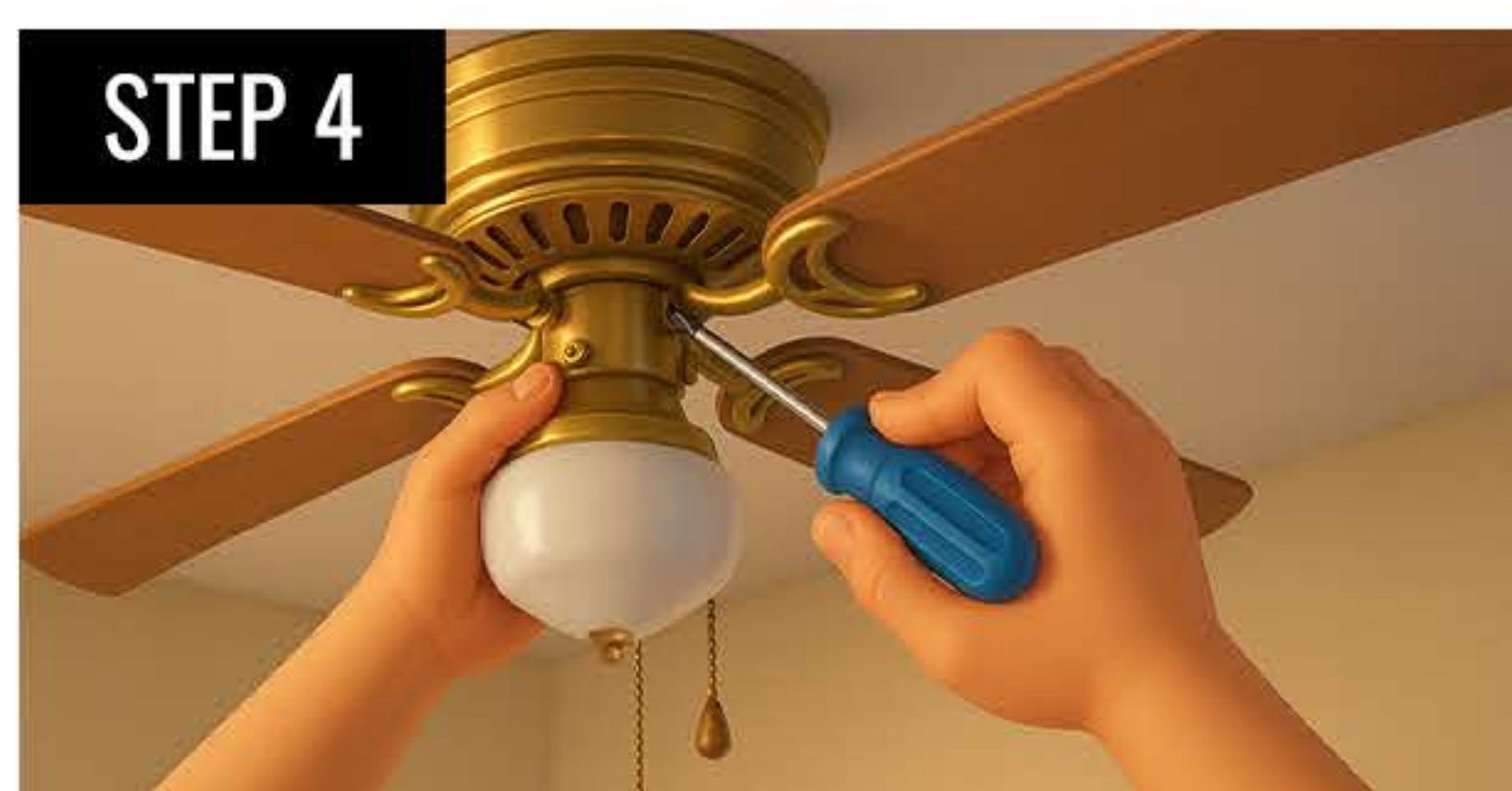

TIGHTEN SCREWS

Check and tighten all screws on the blade arms and mounting bracket.

STEP 5



ALIGN BLADE ARMS

Make sure all blade arms are at the same height and angle.

STEP 6



LABEL THE BLADES

Use painter's tape to number each blade for easier tracking.

STEP 7



PLACE THE BALANCING CLIP

Attach the clip to the center of blade 1 and turn the power back on.

STEP 8



TEST FOR WOBBLE

Turn the fan on and move the clip 1 inch at a time along each blade. Repeat until wobbling stops.

STEP 9



APPLY THE WEIGHT

Align the weight with the clip and glue it to the center of the blade. Remove the Clip.

IF THE STEPS ABOVE DON'T WORK

A. REPLACE THE BLADE

B. CALL A PROFESSIONAL ELECTRICIAN & REPLACE THE CEILING FAN